

TEXAS 4-H YOUTH DEVELOPMENT
DISTRICT 8 4-H ROUNDUP

Contestant Information

- District 4-H Roundup:** Educational Presentations
Public Speaking
4-H Talent Showcase
- Event Date:** Saturday, May 4, 2024
- Location:** McLennan County
West High School
1008 Jerry Mashek Dr.
West, TX 76691
(You will enter in the middle of the buildings-in the mail entrance)
- Entry Deadline:** All entries for District will be completed on 4-H Online at
<https://texas.4honline.com/>.
Check with your County Extension Agent for county entry deadlines.
- Entry Fee:** \$12 per member per event
- Late Entries:** Late entries will be permitted with an additional:
- \$20 late fee per 4-H member up to 60 hours after the regular contest deadline.
 - \$50 late fee per 4-H member after 60 hours and up to the time of check-in on-site at an event
- Resources:** General Roundup:
<http://d84-h.tamu.edu/events-and-activities/roundup/>
<http://texas4-h.tamu.edu/events/roundup/>
- 4-H Talent Showcase:
https://texas4-h.tamu.edu/wp-content/uploads/roundup_talent_showcase_2023.pdf
- Educational Presentations & Public Speaking:
- <http://texas4-h.tamu.edu/projects/public-speaking/>
 - https://texas4-h.tamu.edu/wp-content/uploads/educational_presentation_guidelines.pdf
 - <https://texas4-h.tamu.edu/events/roundup/>

Reminders/Changes:

- **At Texas 4-H Roundup, 4-H Talent Showcase contest categories will be conducted on WEDNESDAY and THURSDAY.** 4-H members will be able to participate in one 4-H Talent Showcase on Wednesday **AND** one on category on Thursday! *(At State Roundup)*
- **All Educational Presentations**
 - Only open to individuals or teams of two.
- **Senior Contest Categories with Single Entries**
 - Senior 4-H members in the following contest categories have the option to participate at District 8 4-H Roundup if they are the only entry at the District level. These contestants are still highly encouraged to attend and compete at District 8 4-H Roundup to improve their skills and to gain feedback from judges. The contests eligible are as follows: Educational Presentations, Public Speaking, and 4-H Talent Showcase.

**Auxiliary Aids or
Special
Accommodations:**

If you have any participants requiring auxiliary aids or special accommodations, please let us know at the time entry materials are due.

DISTRICT 8 4-H ROUNDUP

General Rules & Guidelines

1. Rules and Guidelines

All District contests will be conducted by the rules printed in the District 8 General Rules and Guidelines and in the 2024 Texas 4-H Roundup Guide. If an inconsistency exists, the Texas 4-H Roundup Guide rules will always supersede District policies, rules, and guidelines. All qualifying contests listed in the Texas 4-H Roundup Guide will be included in District Contest provided there are sufficient entries.

2. Membership

Participants must be a bona fide 4-H member, currently enrolled in their respective county program.

3. Age Divisions

There will be three (3) age divisions (Junior, Intermediate, and Senior) in all contests, except those listed below where there will be two (2) age divisions (Junior and Senior).

District 8 Contests with two (2) age divisions:

Dairy Judging

Leaders 4 Life Skillathon

Quiz Bowls (Beef, Horse, Swine, and Nutrition)

Age divisions are determined by a participant's grade as of August 31, 2023 as follows:

| Division | Grades | |
|--------------|-------------------|---|
| Junior | 3*, 4, or 5 | <i>*Must be at least 8 years old</i> |
| Intermediate | 6, 7, or 8 | |
| Senior | 9, 10, 11, or 12* | <i>*Must not be older than 18 years old</i> |

Only Senior aged members may advance to the state qualifying competition at Texas 4-H Roundup.

4. Participation/Entries

4-H members must be certified by the County Extension Agent to participate at any District 4-H event.

Each county may enter the following number of entries at District 8 Contests:

| | |
|---------------------------|--|
| Judging Contests | No limit |
| Educational Presentations | 3 entries per county per age division per category |
| Public Speaking | 3 individuals per county per age division |
| Quiz Bowls | No limit |
| 4-H Talent Showcase | 2 entries per county per age division per category |
| Rifle | No limit |
| Light Rifle | No limit |
| Food Show | 1 entry per county per age division per category |
| Food Challenge | 2 entries per county per age division |
| Fashion Show | 1 entry per county per age division per category |
| Fashion Storyboard | No limit |
| Duds to Dazzle | No limit |
| Leaders 4 Life Skillathon | No limit |

All team members must be from the same county and within the same age division. Exception: Juniors may move up to the Intermediate age division when participating on a team that has true Intermediates (based upon grades listed above) on it. No one may move up to the Senior age division. No individual may move down to a younger age division.

5. **Multiple Entries at District Roundup**

At District 8 4-H Roundup, 4-H members may participate in multiple events. 4-H members of all age divisions may enter a maximum of one contest from each of the columns below. (The days listed at the top of each column below represent the day those contests are offered at Texas 4-H Roundup.)

| Wednesday | Thursday |
|-----------------------------|---|
| 4HTS Choreographed Routines | Agricultural Technology & Farm Safety Ed Pres |
| 4HTS Variety Show | Animal Science Educational Presentation |
| | Beef Educational Presentation |
| 4HTS Vocal | Health & Wellness Educational Presentation |
| 4HTS Musical/Instrumental | Horse Educational Presentation |
| | Open Ag & Natural Resources Educational Pres |
| | Open Family & Community Health Ed Pres |
| | Open Educational Presentation |
| | Promote 4-H Educational Presentation |
| | Public Speaking |
| | Safety & Injury Prevention Educational Presentation |
| | 4HTS 4-H Skit |
| | 4HTS Poetry/Prose |
| | 4HTS Solo/Band |

***At Texas 4-H Roundup, 4-H Talent Showcase (4HTS) will be conducted on WEDNESDAY and THURSDAY.**

4-H members will be able to participate in one 4-H Talent Showcase category on Wednesday **AND** one 4-H Talent Showcase category on Thursday!

https://texas4-h.tamu.edu/wp-content/uploads/educational_presentation_guidelines.pdf

Procedure for participating in multiple District Roundup Events

- 4-H members that are participating in multiple events will need to follow the designated orders that are given at check-in.
- Compete in your contests *in order*. Once you finish one contest, move immediately to your next contest room. Please ask if you have questions.

Seniors Qualifying for more than one Texas 4-H Roundup event held at the same time

Senior age members who qualify for state in contest areas that conflict at Texas 4-H Roundup must choose the contest in which they will advance. Members are encouraged to communicate their decision with their County Extension Agent as quickly as possible so that the District Office may be notified. Once a member declares which contest they are advancing to at Texas 4-H Roundup, the state opportunity in the other contest will be offered to the next qualified placing participant.

Substitutions for Districts 4-H Contests

Each county should determine their own guidelines to follow in their County 4-H Roundup regarding substitutions when they advance to District Roundup.

Senior Substitutions for Texas 4-H Roundup

District 8 will follow the substitution rules as outlined in the current year’s Texas 4-H Roundup Guide. To be an eligible substitute, he/she must have attended and competed in another competitive District 8 4-H event.

6. **Senior Contest Categories with Single Entries**

Senior 4-H members in the following contest categories have the option to participate at District 8 4-H Roundup if they are the only entry at the District level!. These contestants are still highly encouraged to attend and compete at District 8 4-H Roundup to improve their skills and to gain feedback from judges. The contests eligible are as follows: Educational Presentations, Public Speaking, and 4-H Talent Showcase.

If the single entry does not attend District 8 4-H Roundup, the County Extension Agent MUST witness and certify the entry after the District 8 4-H Roundup entry deadline. The County Extension Agent must notify the District Office by the Texas 4-H Roundup registration deadline.

7. Academic Eligibility of Participants

According to the Texas Education Code, a 4-H member must be deemed “eligible” to compete in an event that takes place on a weekday or weekend. All 4-H youth, including youth in public, private, and/or home school must adhere to the following guidelines regarding extracurricular activities and academic eligibility:

- Complete a “Declaration of Eligibility Form”
OR
- Name of 4-H member must appear on a list of eligible students to participate in a specific extracurricular activity signed by the school principal or designee.

If a 4-H member is ineligible for a 4-H competitive event, the agent must notify the 4-H member, his/her parents, and the district office, by letter, of this situation. If the parent has any questions, he/she should be referred to the school administrator.

8. Entries

All contest entries must be submitted through 4-H Connect and are due no later than the indicated dates.

9. Entry Fee

There is a \$12 entry fee per member per contest. All entries must be submitted through 4-H Connect by the entry due date.

10. Late Fees

Late entries will be permitted with an additional:

- \$20 late fee per 4-H member up to 60 hours after the regular contest deadline.
- \$50 late fee per 4-H member after 60 hours and up to the time of check-in on-site at an event

11. Topic Subject (*Educational Presentations & Public Speaking*)

Subjects in the educational presentation categories should address emerging or current issues in each of the contest areas. Some contests provide a suggested list of topics that the educational presentation may cover along with a resource list. Senior contestants are encouraged to research these emerging and/or current issues to develop presentations.

12. Accuracy of Information/Resources (*Educational Presentations & Public Speaking*)

With the computer and internet being used heavily in educational presentations, 4-H members must know the difference between research and nonresearched based information. Contestants are required to use information that is factual and can be supported through adequate documentation. Examples of such websites are federal, state, and local governments, independent research sites, and Texas A&M AgriLife Extension Service websites. Internet information that is questionable includes personal documentation sites, chat rooms, message boards, etc. 4-H members must prepare a list of references (i.e. bibliography, works cited) for their presentation.

13. Subject Matter (*Educational Presentations & Public Speaking*)

The skills and knowledge used in any 4-H contest should be the result of experiences in a project in which the member has participated. A presentation must relate to the contest entered, contain current information, and not be better suited for another contest. It should also be appropriate for the member’s age and experience. Appropriate credit must be given for references used.

14. **Time Limits**

Educational Presentations: Contestants are permitted twelve (12) minutes for each Educational Presentation. An additional nine (9) minutes will be provided for on-stage arrangements and cleanup in connection with the presentation. A penalty of two (2) points per minute or partial minute overtime will be deducted from the final score. Following the presentation, there may be up to five (5) minutes of question and answer period by the judge. Adults are permitted to assist the 4-H member with the on-stage arrangement and cleanup in connection with the presentation.

Public Speaking: a five to seven (5-9) minute talk suitable as a platform speech or radio broadcast.

4-H Talent Showcase: a six (6) minute presentation with four (4) minutes total for set up and take down.

15. **Visuals**

In Educational Presentation categories, the use of charts, photographs, computer presentations, graphics/programs, and other visual materials are permitted. Visuals should contribute to the presentation. Each presentation is an example of the participant's ability to communicate an idea. No firearms, weapons, fireworks, open flamed burners, live ammunition, or live animals are allowed to be used by a contestant in any Roundup contest. However, posters and pictures of such items are allowed and encouraged. We encourage all visuals to be appealing to the audience and easily read/seen by the audience. Choose your visual taking that into consideration.

Visual aids and props may not be used in Public Speaking.

16. **Video, Audio, and Display Equipment** (*Educational Presentations*)

The contest officials will provide laptops, extension cords and projectors. Youth should have all presentations in some form of Microsoft Office (PowerPoint, Word, or Excel). All fonts used must be true type. These fonts specifically include Arial and Times New Roman. If contestants decide to use any other program or fonts, they will be responsible for bringing *all* equipment that is compatible with their presentation.

The contest superintendent will bring a standing easel. Contestants are responsible for all other needed materials and equipment.

Take into consideration that Internet connectivity may not be available. Be prepared to incorporate any video or other graphics that may require Internet to be directly embedded in the presentation. Make sure the image/ video is included as part of the thumb drive or method used to provide your presentation to the contest Superintendent/Coordinator.

17. **Judges Gifts/Handouts**

Gifts of any kind may not be presented to the judges in any contest. Handout may be made available to the entire audience.

18. **Judges Questions on Educational Presentations**

Judges may ask contestants questions at the end of their presentation. Following the presentation, there may be up to 5 minutes of question-and-answer period by the judges. Only official judges and superintendents may ask questions of the contestants.

19. **Scorecards**

The 4-H Educational Presentation Score Sheet will be used by contest judges in scoring Educational Presentations regardless of presentation style (method demonstration, illustrated talk, or speech). Public Speaking scorecards will be used by contest judges in scoring Public Speaking. Score sheets are available on

the District 8 4-H Youth Development website under the Roundup page or also on the Texas 4-H website at the following links:

https://texas4-h.tamu.edu/wp-content/uploads/public_speaking_score_sheet_2024.pdf

https://texas4-h.tamu.edu/wp-content/uploads/roundup_educational_presentation_score_sheet_2024.pdf

4-H Talent Showcase scorecards (revised 2022) will be used by contest judges in scoring 4-H Talent Showcase acts and can be found at the following link:

https://texas4-h.tamu.edu/wp-content/uploads/talent_showcase_scoresheet_2024.pdf

20. 4-H Talent Showcase Equipment

All props and equipment will be the responsibility of the 4-H member. (This includes CD players/radios, extension cords, speakers, amplifiers, keyboards, etc.) There will be no extra equipment provided. Contestants will be responsible for bringing all the equipment needed to successfully perform their act. No props will be allowed to lean on walls in the hall or on stage. They must be free standing. *There will be no piano provided.*

21. Auxiliary Aids/Special Accommodations

If 4-H members that are participating in District 4-H events require auxiliary aids or special accommodations (including time constraints or conflicts), please notify the District Office at the same time that entry materials are due.

22. Change of Entry Forms

If, after approving county entries, substitutions are necessary, contact the District 8 4-H Specialist to conduct the change. This change may begin with a phone call, but any official changes must come in writing prior to the contest.

23. Qualifying for State

Only Senior 4-H members are eligible to advance to state.

| | |
|---------------------------|--|
| Educational Presentations | first, second, and third place in each category |
| Public Speaking | first, second, and third place individuals |
| 4-H Talent Showcase | first and second place in each of the seven categories |

24. Contest Room

The door to the contest room will only open briefly between presentations. If seating is available after contestants are seated, others are encouraged to watch the contests, but will not be allowed to enter or leave the contest room during a presentation.

District 8 4-H Roundup

West High School-First Floor

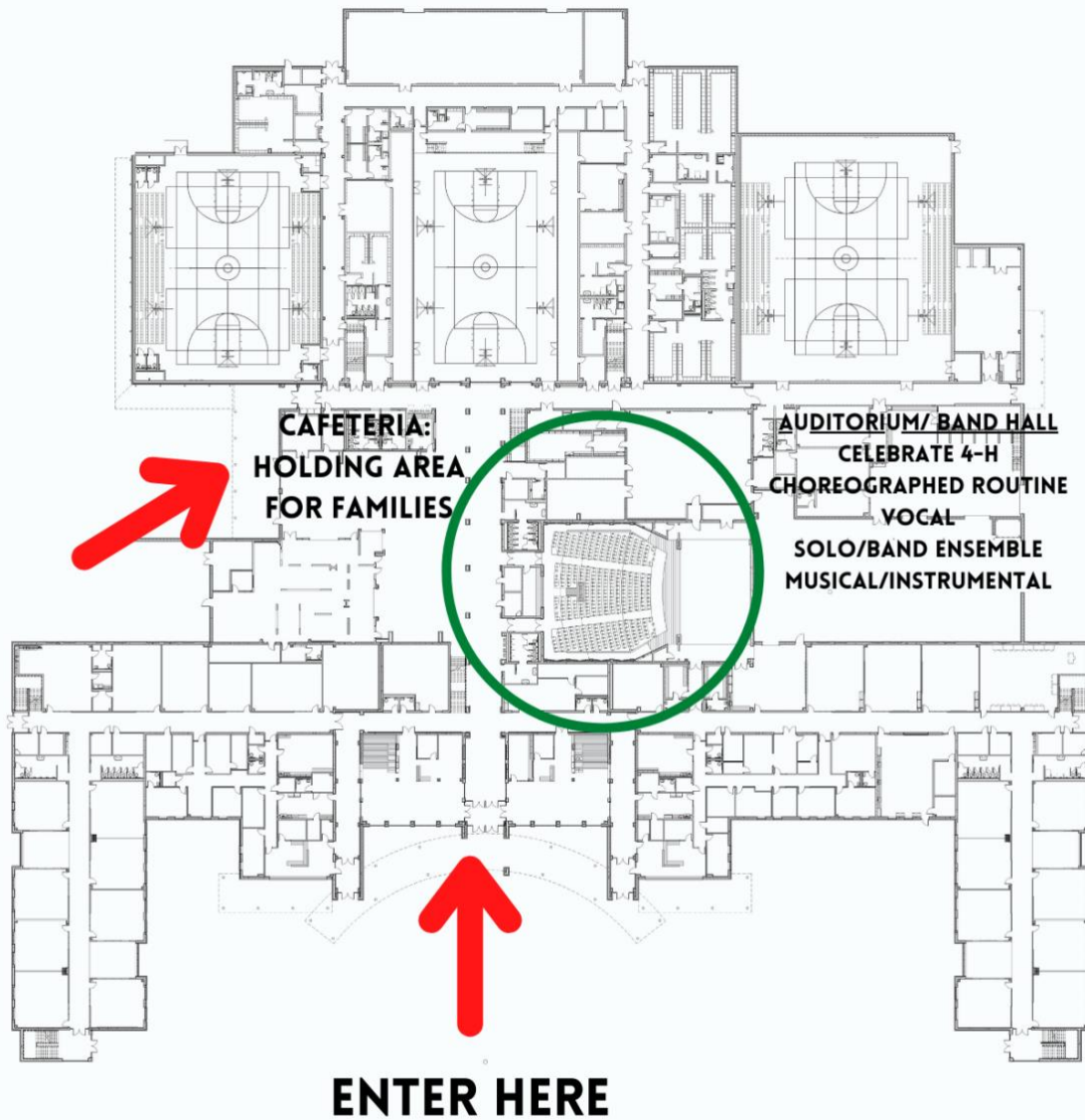

District 8 4-H Roundup

West High School-Second Floor

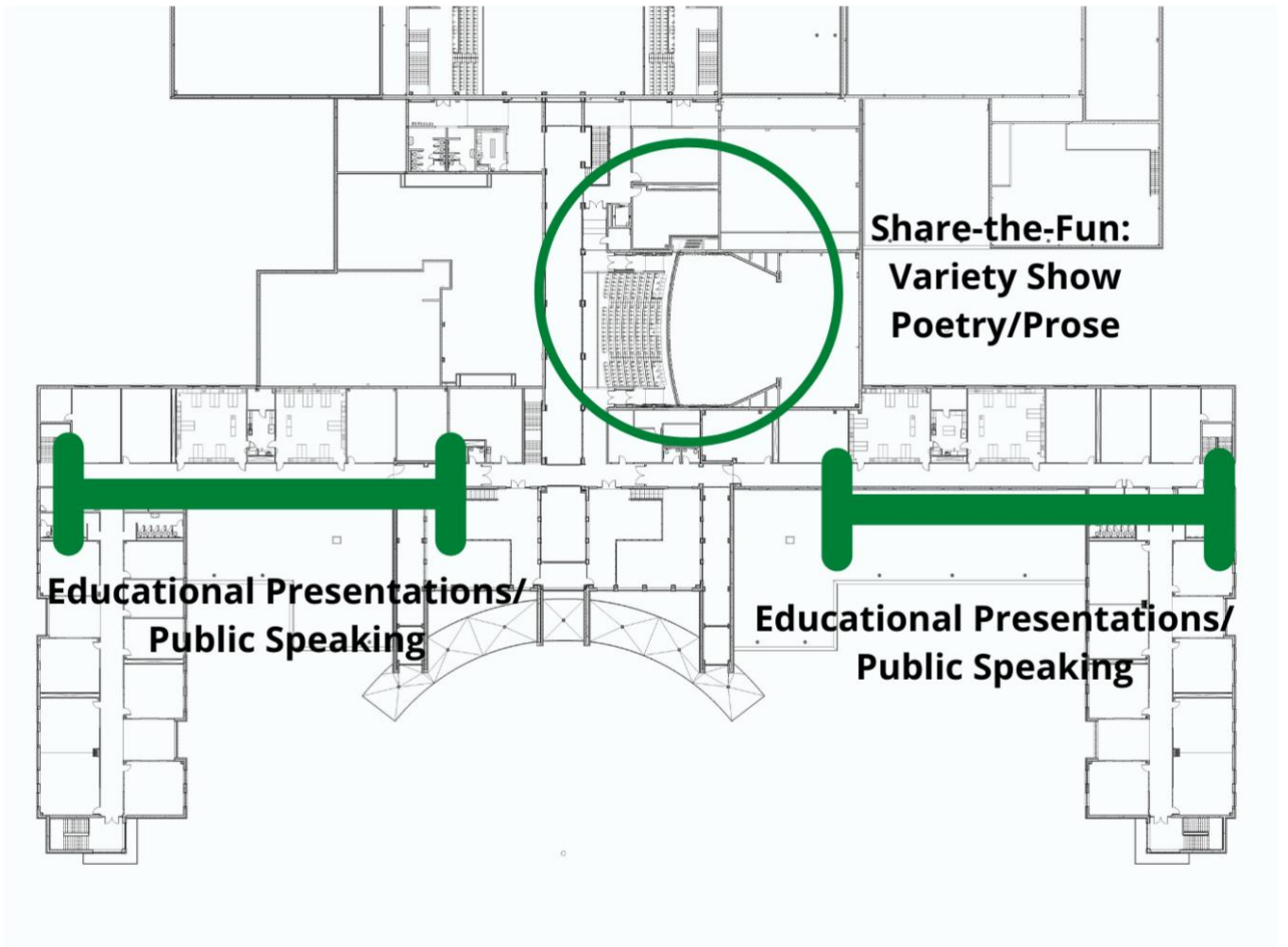

DISTRICT 8 4-H ROUNDUP

Schedule & Locations • West, Texas • Saturday, May 6, 2023

4-H Talent Showcase Schedule

| Schedule | | All locations are TBD |
|----------------|--|--------------------------|
| 7:45 am | Agents & Council Officers Arrive | |
| 7:45 am | Superintendents check their room set-up (<i>before Orientation</i>) | <i>See list below</i> |
| 8:00 – 8:15 am | 4-H Talent Showcase Superintendents & Judges Check-in | Teacher's Lounge |
| 8:15 am | 4-H Talent Showcase Superintendents & Judges Orientation | Teacher's Lounge |
| 9:00 am | 4-H Talent Showcase Opening Assembly & Orientation | Auditorium |
| 9:30 am | Contestant Check-in (<i>in contest rooms</i>) (4-H Talent Showcase) | <i>See list below</i> |
| 9:45 am | Contests Begin (<i>in contest rooms</i>) (4-H Talent Showcase) | <i>See list below</i> |

Awards will be immediately following judging in each contest room.

| Share the Fun Room Locations | |
|---|-------------------------|
| Tabulation | Teacher's Lounge |
| Information/Photo Area | Cafeteria |
| 4-H Talent Showcase – ROOM O 4-H Skit, Jr/INT Poetry Prose | Downstairs Classroom |
| 4-H Talent Showcase – ROOM P Choreographed Routine | Auditorium (Stage) |
| 4-H Talent Showcase –ROOM Q Jr Musical/Instrumental, Jr Vocal, Int. Solo/Band, Int. Variety | |
| 4-H Talent Showcase – ROOM R Int. Vocal, Int. Musical/Inst. | Band Ensemble Room 1 |
| 4-H Talent Showcase – ROOM T Sr. Musical/Instrumental | |
| 4-H Talent Showcase – ROOM U Sr. Poetry/Prose Sr. Variety Show | Second Floor Auditorium |
| 4-H Talent Showcase – ROOM V Sr. Solo Band | Band Ensemble Room 2 |
| 4-H Talent Showcase – ROOM W Sr. Vocal | Downstairs Classroom |

DISTRICT 8 4-H ROUNDUP

Schedule & Locations • West, Texas • Saturday, May 6, 2023

Educational Presentations & Public Speaking

| Schedule | | All locations are TBD |
|---|--|--------------------------|
| 7:45 am | Agents & Council Officers Arrive | |
| 9:45 am | Superintendents check their room set-up (<i>before Orientation</i>) | <i>See list below</i> |
| 10:00-10:30 am | Superintendents & Judges Check-in | Teacher's Lounge |
| 10:30 am | Superintendents & Judges Orientation | Teacher's Lounge |
| 10:45 am | Opening Assembly & Orientation | Cafeteria |
| 11:00 am | Contestant Check-in (<i>in contest rooms</i>) (<i>Educational Presentations, Public Speaking</i>) | <i>See list below</i> |
| 11:00 am | Contests Begin (<i>in contest rooms</i>) (<i>Educational Presentations, Public Speaking</i>) | <i>See list below</i> |
| <i>Awards will be immediately following judging in each contest room.</i> | | |

| Educational Presentation Room Locations | |
|---|------------------------|
| Tabulation | Teacher's Lounge |
| Information/Photo Area | Cafeteria |
| Educational Presentation Room A | Second Floor-Classroom |
| Educational Presentation Room B | Second Floor-Classroom |
| Educational Presentation Room C | Second Floor-Classroom |
| Educational Presentation Room D | Second Floor-Classroom |
| Educational Presentation Room F | Second Floor-Classroom |
| Educational Presentation Room H | Second Floor-Classroom |
| Educational Presentation Room J | Second Floor-Classroom |
| Educational Presentation Room K | Second Floor-Classroom |
| Educational Presentation Room L | Second Floor-Classroom |
| Educational Presentation Room M | Second Floor-Classroom |
| Educational Presentation Room N | Second Floor-Classroom |